



TM

Submittal Sheet

Insulation Support System

Information

ULTRA-GRID - The ULTRA-GRID Basket System is designed to support a multi-layer insulation system for new buildings including bar joist construction. This system allows for maximum insulation recovery, durable long lasting support and an attractive finish.

Description

Basket System - consists of durable white painted "Hat" and "C" shaped channels. Each basket is preassembled according to each jobs specifications.

Designed for pre-engineered metal buildings, the Basket System is a double layer insulation support system custom built for each building and requires no tools or extra parts for installation.. Attaching to both "Z" and "C" purlins, the Basket System works by hooking over one purlin and resting on the flange of the opposite purlin. The preassembled "Hat" and "C" channels provide the ultimate support for a double layer insulation system.

Applications

Metal Buildings

- New Construction (All systems)
- Commercial
- Industrial
- Agricultural

BASKET SYSTEM

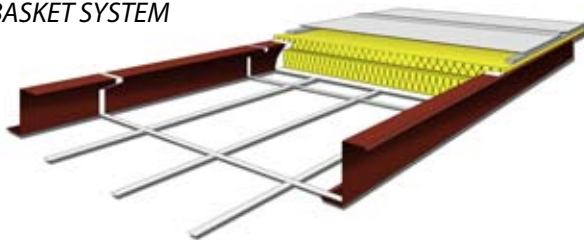

Advantages

- Achieve Higher R-Values
- Quick and Easy to Install
- Clean and Professional
- Ultimate Insulation Support
- New Buildings
- Long Lasting

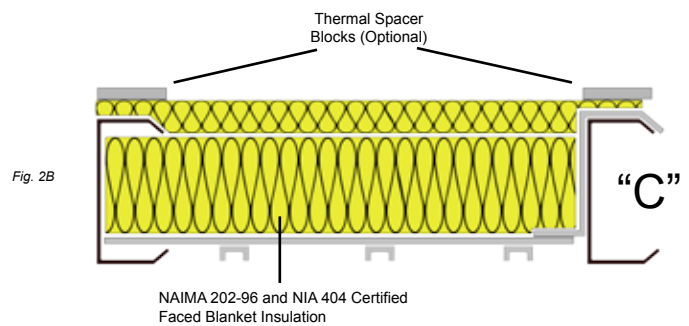
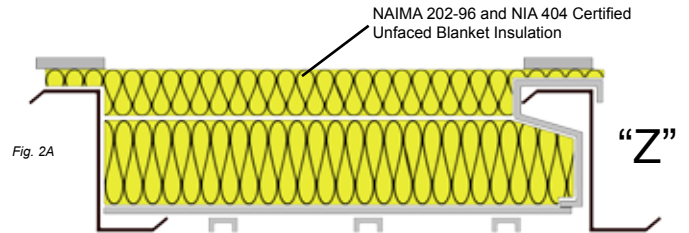

Installation

BASKET SYSTEM

(Figure 2A and 2B)

Place the hooked side of the grid over the purlin and allow the other side to rest on the flange of the opposing purlin. Place 2 grids per bay spaced apart evenly. Do not overlap or butt together. Figure 2A and 2B show how the grids lay into place with either a "Z" or "C" purlin. No fasteners are needed.

INSTALLING THE INSULATION

New Building

Installing a Double Layer Insulation System

Unroll and place first layer of certified faced fiberglass insulation in between the purlins and on top the installed baskets. Selle Supply's certified faced fiberglass insulation is delivered custom cut to fit each bay (plus 12 inches to allow for handling and stretching). Make sure the insulation is free from obstructions that could restrict it from fully recovering.

It's very important to ensure the tabs on the faced fiberglass insulation are overlapping to maintain a consistent vapor retarder. Use tape every few feet or so to keep the tabs from separating during installation.

Unroll and position the second layer of certified unfaced fiberglass insulation on top of the purlins. Second layer of insulation should be perpendicular to the purlins and on top of the already installed faced fiberglass insulation. Thermal Spacers are highly recommended to help obtain higher R-Values.

It is strongly recommended to use only 3rd party certified metal building insulation. NAIMA-202 96 and NIA 404 certified post laminate insulation provides optimal recovery value ensuring the entire cavity is filled.

If you have any questions regarding the ULTRA-GRID products or product installation, please contact your local sales representative using the toll free number or email sales@sellesupply.com



LUBBOCK

4602 Locust Ave
Lubbock, Texas 79404
Phone: (806) 747-3691
Fax: (806) 744-3855
Toll Free: (800) 937-3553

EL PASO

7344 Stiles Drive
El Paso, Texas 79915
Phone: (915) 772-8525
Fax: (915) 778-0176
Toll Free: (800) 926-3499

ALBUQUERQUE

6711 Edith Blvd. Suite A
Albuquerque, NM 87113
Phone: (505) 843-7255
Fax: (505) 843-6737
Toll Free: (800) 234-4253